

3/15a Wrights Road

STYLISH TOWNHOME WITH DOUBLE PARKING - AUCTION ON SITE SATURDAY 2 APRIL AT 11.15AM

One of only four in a tightly held collection, this tastefully renovated townhome is secluded from the road in a premier East Side setting with a superb bay outlook from the stylish master suite. A spacious layout features whole-floor living and entertaining space flowing to an easy-care courtyard with the bonus of double parking and a private entry. Enjoy the best of village convenience and bayside living just 300m (approx) to Taplin Park and Five Dock boat ramp. * Recently renovated, light and... for more information please visit our website
Disclaimer: In preparing this brochure, Warwick Williams and its related franchisees has relied in good faith upon information provided by others and has made all reasonable efforts to ensure that the information is correct. The accuracy of the information provided to you (whether written or verbal) cannot be guaranteed. If you are considering this property, you must make all enquiries necessary to satisfy yourself that all information is accurate.

CAR	BATH	BED
2	2	2

SOLD

Sold



Adrian Sereni 02 9719 8288
adrians@wwre.com.au



GROUND FLOOR

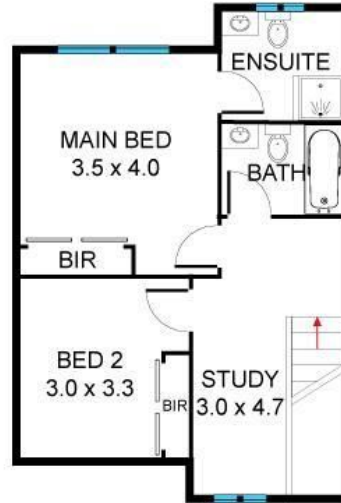

FIRST FLOOR

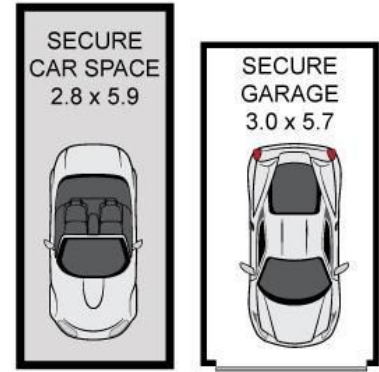

BASEMENT



Scale in metres. Indicative only. Dimensions are approximate. All information contained herein is gathered from sources we believe to be reliable. However, we cannot guarantee its accuracy and interested persons should rely on their own enquiries.

3/15a Wrights Road, Drummoyne