



7/28 Bay Road

STYLE, SUNSHINE AND SPARKLING WATER VIEWS

Well located just one street back from the foreshore, this charming boutique first floor apartment is set to the rear of a smart security block, capturing views over Five Dock Bay from the bedrooms and north facing balcony. Open plan living and dining serviced by a sleek kitchen, bright and airy double bedrooms and water glimpses, the main with built ins and a balcony make for very comfortable living. • Well maintained security block of only 8 units • Freshly painted throughout &bull... for more information please visit our website

Water Rate | \$583

Council Rate | \$1,152

Disclaimer: In preparing this brochure, Warwick Williams and it's related franchisees has relied in good faith upon information provided by others and has made all reasonable efforts to ensure that the information is correct. The accuracy of the information provided to you (whether written or verbal) cannot be guaranteed. If you are considering this property, you must make all enquiries necessary to satisfy yourself that all information is accurate.

CAR	BATH	BED
1	1	2

SOLD

Sold



Morgan Davies-Forsyth 02 9719 8288

morgand@wwre.com.au

Warwick Williams 02 9719 8288

ww@wwre.com.au

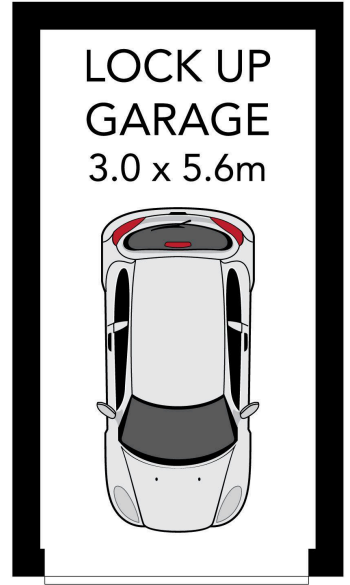
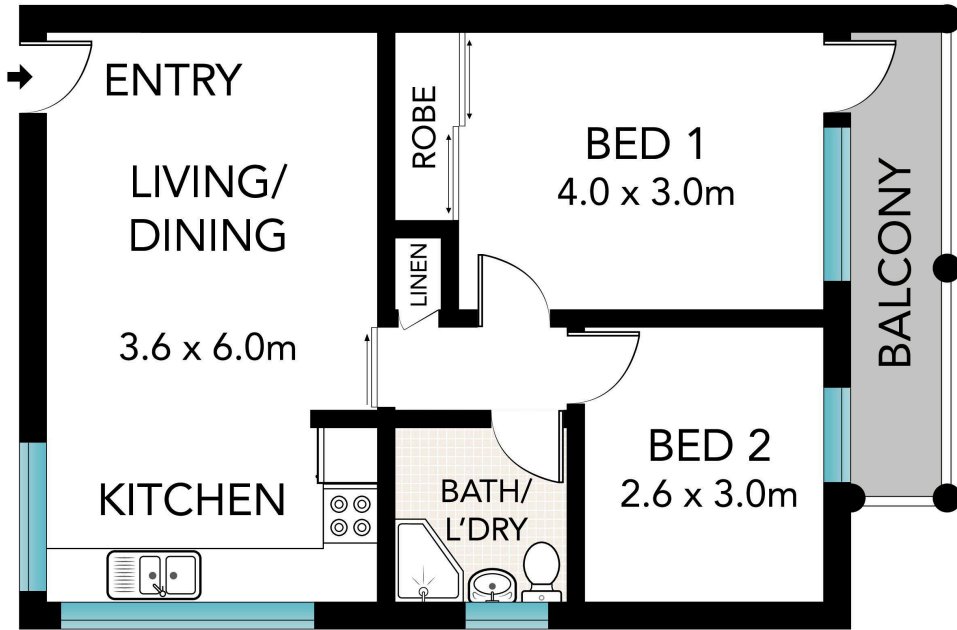

7/28 BAY ROAD, RUSSELL LEA

All information in this document has been gathered from various third party sources we believe to be reliable; however, we cannot guarantee its accuracy, and we accept no responsibility and disclaim all liability in respect to any errors, omissions, inaccuracies or misstatements in this document. Prospective purchasers are advised to carry out their own investigations and rely on their own enquiries.